

Specifications
Standard Version (Compatible Baumer Models : DI, DJ, DK & DM)

Flange Size	:	1/2" to 5" as per ANSI B 16.5
Material	:	AISI 316 SS
Number of ports	:	Two
Port Connection	:	1/4" NPT (F) with Male plug
Sealing Face	:	Suitable to Raised Face of Flange

Special Features

- With double flushing ports.
- Suitable with flanged, pancake or inline diaphragm seals.
- Available in all exotic material grades.

Application

- The flushing ring is designed to be sandwiched between the process flange & the diaphragm seal.
- Material collected in front of diaphragm can be flushed out through the flushing ports.

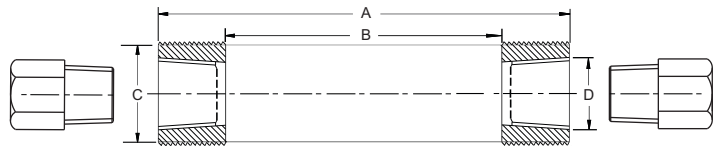
Dimensions - Standard Version

For flange type diaphragm seals

Flange Size	Class	A	B	C	D
1/2"	150 # to 600 #	35	12	30	1/4" NPT or 1/2" NPT (F)
3/4"	150 # to 600 #	43	20	30	
1"	150 # to 600 #	51	25	30	
1 1/2"	150 # to 600 #	73	43	30	
2"	150 # to 600 #	92	62	30	
3"	150 # to 600 #	127	92	30	
4"	150 # to 600 #	157	92	30	
5"	150 # to 600 #	185.5	126	30	

Note: other sealing face and higher pressure rating flushing rings on request. Please specify.

Notes :

- Drawings are not to scale.
- All Dimensions are in mm.

How To Order
Basic Model
Code
Optional Extras
Flange Size (As per ANSI B 16.5) (* Consult factory for drawings of these Baumer models)

1/2" 3/4" 1" 1 1/2" 2" 3" 4" 5" D0* DB* DI*

Flange Rating (Do not select if DA or DB required)

150 300 400 600

Sealing Face
A2 Raised Face (Standard) **A3** Flat Face

Flushing Ring Material

KM AISI 316L SS	KV Carbon steel	KX Titanium
KY Hastelloy C	KW Monel	CT AISI 316 SS (Standard)

Flushing Ports (with two male plugs)

VF 1/4" NPT (F) (Standard) **VD** 1/2" NPT (F)

Options **GH** Material test certificates* **TF** Conformity as per NACE Standard

* Material test certificates will be provided for wetted parts only with chemical composition testing. For others, please consult factory.

Ordering example: EE . X OR XX . XXX . XX . XX . XX . XX

Note : Specifications and dimensions given in this product catalogue represents the state of engineering at the time of printing.

Modifications may take place and materials specified may be replaced by others without prior notice.

Example

EE

X

OR

XX

XXX

XX

XX

XX

XX